

With its heavy-duty cast-iron construction, ability to dry-prime and re-prime automatically, this end-suction centrifugal pump leads the industry in construction, industrial and mining applications. The Thompson 12JSCJ-DJDS-45H-M ENVIROPRIME® Solids Handling Jet Pump is designed for high flows to 7,300 gpm and moderate heads to 102 feet making it perfect for sewage bypass pumping or general construction dewatering.

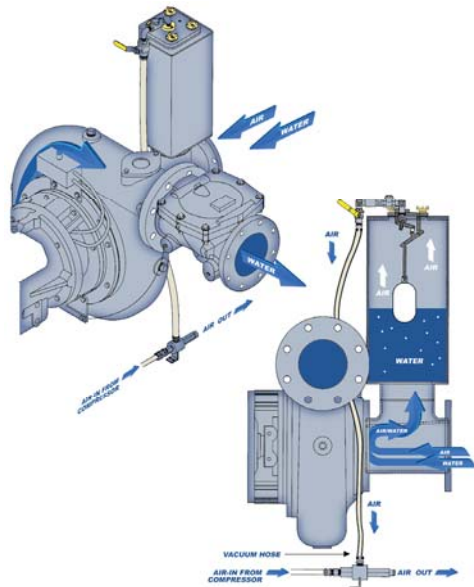

Consult factory for other versions & options including site trailers, sound attenuation, etc.

ENVIROPRIME SYSTEM® with Compressor

- Thompson's innovative priming system preventing blow-by of sewage, effluent and waste from discharging onto the ground. This system, with Thompson's compressor priming system, offers mid-range air handling capabilities for quick priming.

Materials	
Pump Casing	Heavy-duty class 30 cast-iron
Impeller	Dynamically balanced, non-clogging, enclosed, 65-45-12 ductile-iron, with rear-equalizing vanes to reduce axial loading and prolong seal and bearing life; diameter 12.88" x 27°
Mechanical Seal	3" run-dry oil lubricated with Tungsten Carbide rotating and Silicon Carbide stationary seal faces. Single inside mounted, non-pusher type with self-adjusting elastomeric bellows. Other components are 304 stainless steel and viton.
Bearings & Frame	Heavy-duty bearing, grease lubricated to carry both axial and radial loads, Heavy-duty class 30 cast-iron frame
Suction Wear Ring	Replaceable, 65-45-12 ductile iron
Shaft	'Stress-proof' steel and fitted with a renewable 416 stainless steel shaft sleeve
Head	Rugged, back pull out design, heavy duty class 30 cast iron with tapered bore design

TECHNICAL SPECIFICATIONS

Suction Size	12" (30.48 cm)	Approximate Dry Weight	6270 lbs (2844 kg)
Discharge Size	12" (30.48 cm)	Fuel Tank	127 Gal (480 L)
Maximum Flow Capacity	7,300 gpm (1657 m ³ /h)	Fuel Consumption @ 1,800 rpm	6.61 GPH (25 L/h)
Maximum Head	102 ft (31 m)	Best Efficiency Point	68 %
Maximum Solids Handling	3" (7.62 cm)	Maximum Operating Times	Fuel Economy
Maximum Operating Speed	1,800 rpm	19 hours @ 2,000 rpm	.350 lb/hp-hr@2,000 rpm
Maximum Operating Temp.	200°F (93.33°C)	21 hours @ 1,800 rpm	.351 lb/hp-hr@1,800 rpm
Maximum Operating Pressure	44 psi (304 kPa)	30 hours @ 1,600 rpm	.360 lb/hp-hr@1,600 rpm

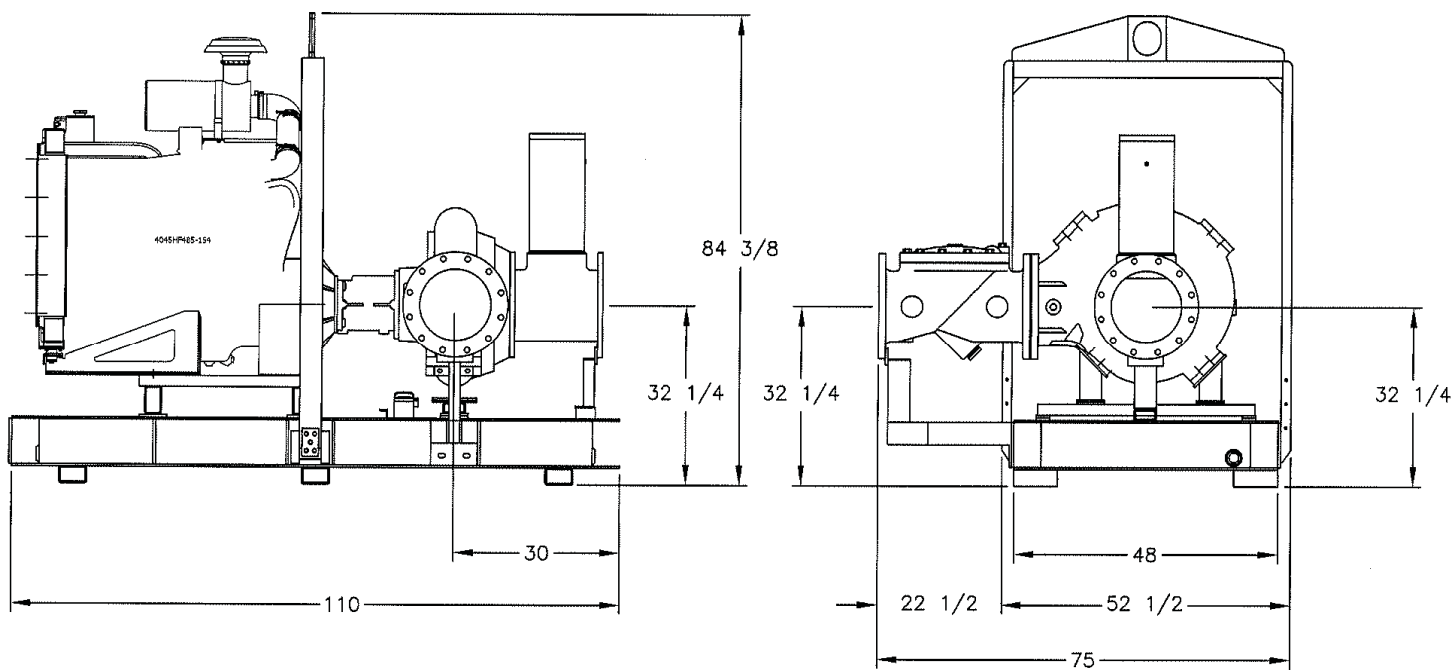
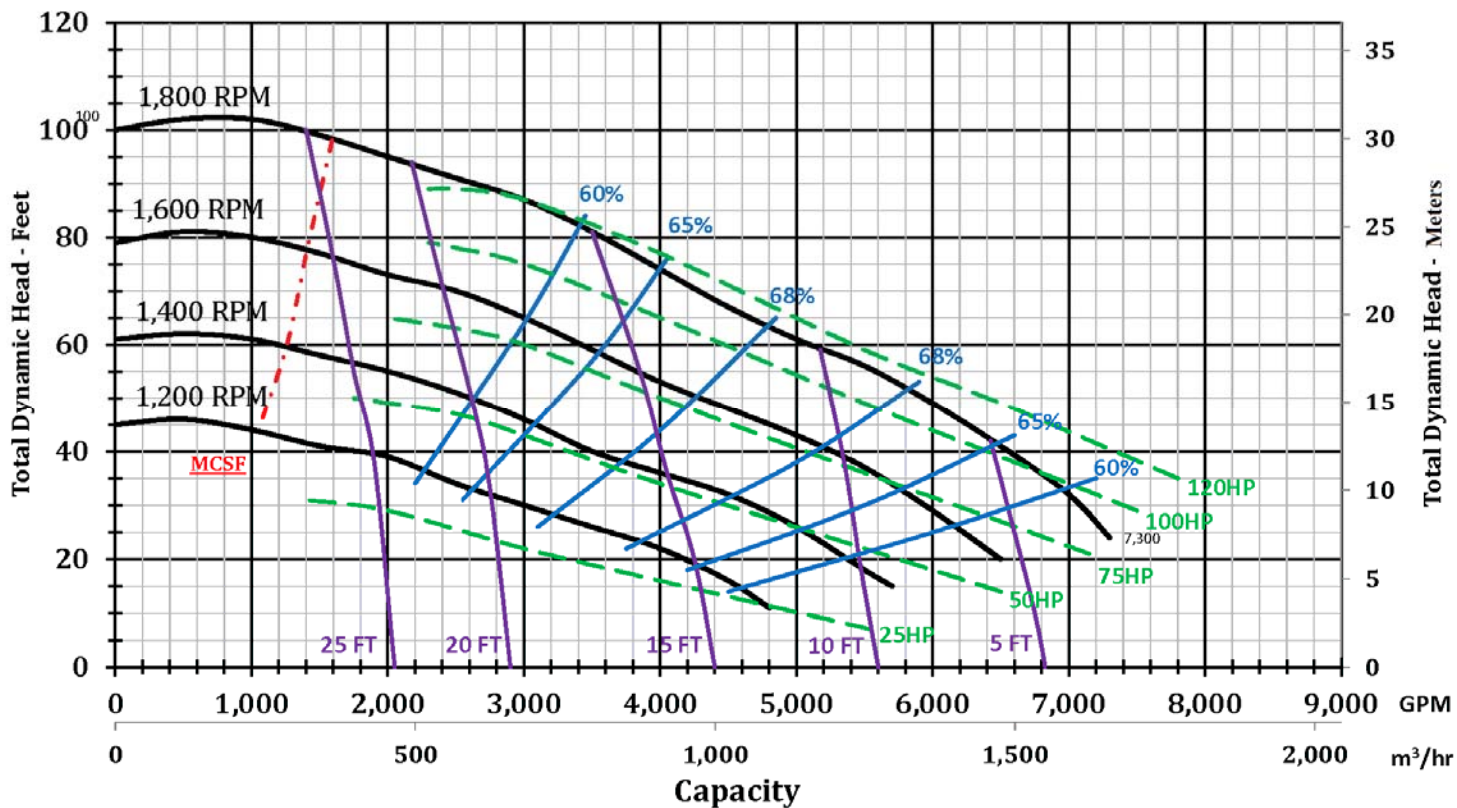

Engine Specification

Engine Model	John Deere 4045H, 139 hp @ 1,800 rpm	Standard Equipment	Alternator, radiator, muffler and exhaust stack with rain protection
Type	4-cylinder, in-line, 4-cycle, water-cooled, turbo charged, direct-injected, Tier III die-	Automatic Shutdowns	High coolant temperature; Low oil pressure

Specifications and illustrations are subject to revision without notice and without incurring any obligation for previous or subsequent equipment sold. Thompson Pump (ISO 9001:2008) makes no representation regarding the completeness or accuracy of this information and is not liable for any direct or indirect damages arising from or relating to this information or its use. Capacity & Head are shown for comparative purposes. Consult Thompson factory for exact capabilities.